

PRODUCT INFORMATION PACKET

marathon[®]
Motors

Model No: 213TTFN16101
Catalog No: L411B
2/1.5,900/750,TEFC,213T,3/60/50/230/460#190/380
Totally Enclosed Fan Cooled (TEFC)



Regal and Marathon are trademarks of Regal Beloit Corporation or one of its affiliated companies.
©2018 Regal Beloit Corporation, All Rights Reserved. MC017097E

REGAL[®]

Nameplate Specifications

| | | | |
|----------------------------|------------------------------------|------------------------|-------------------|
| Output HP | 2 Hp | Output KW | 1.5 kW |
| Frequency | 60 Hz | Voltage | 230/460 V |
| Current | 8.0/4.0 A | Speed | 885 rpm |
| Service Factor | 1.15 | Phase | 3 |
| Efficiency | 86.5 % | Duty | Continuous |
| Insulation Class | F | Design Code | B |
| KVA Code | L | Frame | 213T |
| Enclosure | Totally Enclosed Fan Cooled | Overload Protector | No |
| Ambient Temperature | 40 °C | Drive End Bearing Size | 6307 |
| Opp Drive End Bearing Size | 6208 | UL | Recognized |
| CSA | Y | CE | Y |
| IP Code | 43 | | |

Technical Specifications

| | | | |
|-----------------------|------------------------------------|-----------------------|------------------------|
| Electrical Type | Squirrel Cage Induction Run | Starting Method | Across The Line |
| Poles | 8 | Rotation | Reversible |
| Mounting | Rigid base | Motor Orientation | HORIZONTAL |
| Drive End Bearing | BALL | Opp Drive End Bearing | BALL |
| Frame Material | Cast Iron | Shaft Type | T |
| Overall Length | 19.63 in | Frame Length | 9.12 in |
| Shaft Diameter | 1.375 in | Shaft Extension | 3.38 in |
| Assembly/Box Mounting | F1/F2 CAPABLE | | |
| Outline Drawing | 037659-912 | Connection Diagram | EE7308 |

B

B

A

A

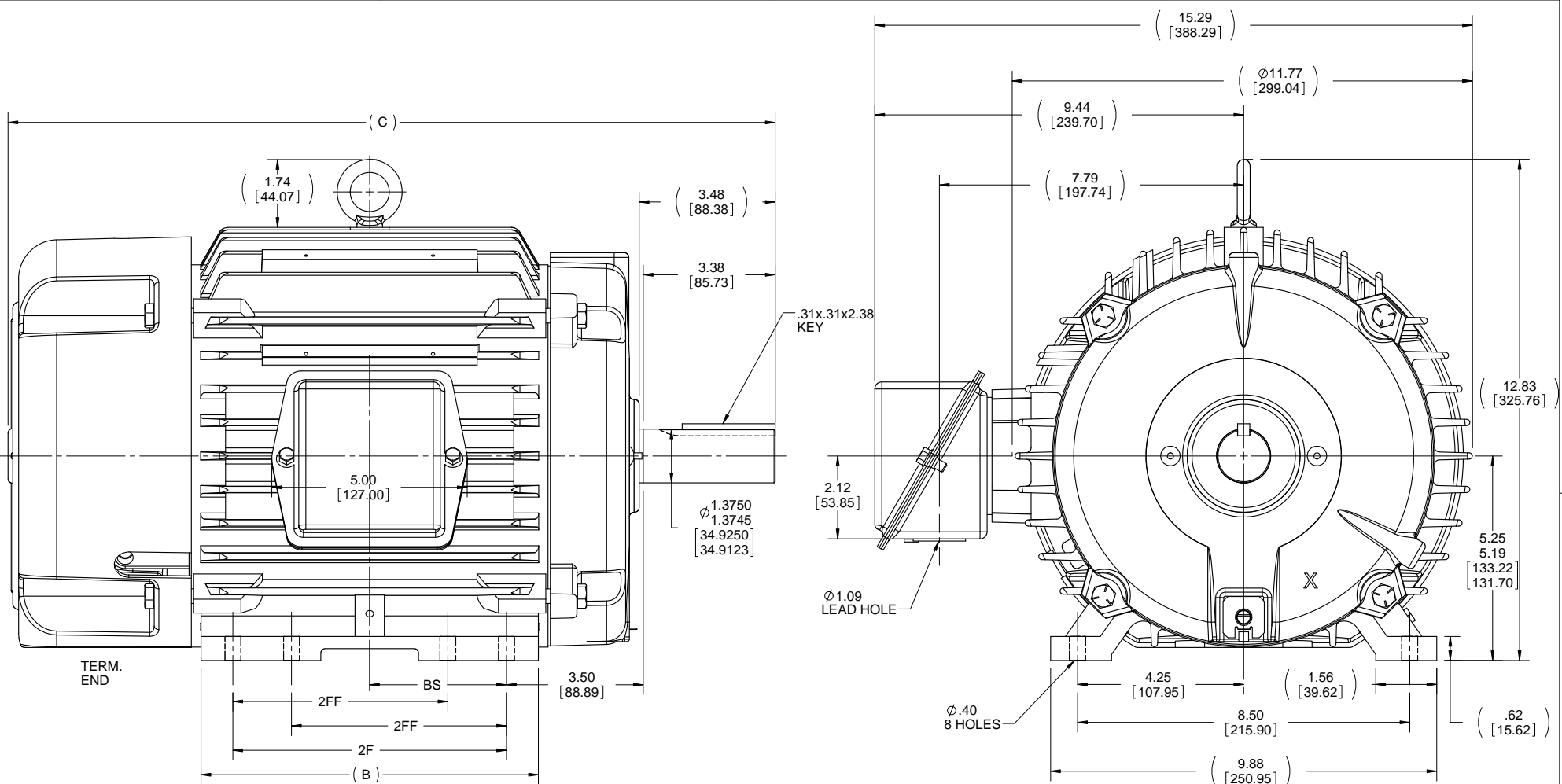

NOTES:

1. CONDUIT BOX CAN BE ROTATED IN 90° STEPS.
2. CONDUIT BOX CAN BE MOUNTED IN OPPOSITE SIDE BY REMOVING BRACKETS AND TURNING FRAME 180°.
3. NAMEPLATE TO BE READ FROM CONDUIT BOX SIDE OF MOTOR.

| | | | | | | |
|------|---------|-------------------|-------------------|-------------------|------------------|------------------|
| 1212 | 213/215 | 22.63 [574.80] | 11.76 [298.70] | 10.00 [254.00] | 7.00 [177.80] | 5.00 [127.00] |
| 912 | 213/215 | 19.63 [498.60] | 8.63 [219.20] | 7.00 [177.80] | 5.50 [139.70] | 3.50 [88.90] |
| DASH | FRAME | C | B | 2F | 2FF | BS |

| | | |
|---|---------------------------|-------------------|
| DRAWING REVISION D | REVISION BY M. VERBICK | DATE 5-29-2015 |
| ECO ECO-0078542 | APPROVED BY | DATE |
| ECO DESCRIPTION TITLE BLOCK LOGO CHANGE | | |
| <small>COPYRIGHT REGAL BELOIT AMERICA, INC. ALL RIGHTS RESERVED. PROPRIETARY AND CONFIDENTIAL INFORMATION - THIS DOCUMENT IS THE PROPERTY OF REGAL BELOIT AMERICA, INC. (OWNER) AND CONTAINS OWNER'S PROPRIETARY INFORMATION. ANY PERSON, CORPORATION OR OTHER FIRM RECEIVING IT IS DEEMED, BY RECEIVING IT, TO AGREE THAT IT, AND/OR ANY PART OF IT, SHALL NOT BE DISCLOSED TO ANY PERSON, CORPORATION OR OTHER ENTITY, DUPLICATED, AND/OR USED, EXCEPT AS EXPRESSLY APPROVED IN WRITING IN ADVANCE BY OWNER. THIS DOCUMENT SHALL BE RETURNED TO OWNER UPON REQUEST. IT MAY BE SUBJECT TO CERTAIN RESTRICTIONS UNDER APPLICABLE EXPORT CONTROL LAWS AND REGULATIONS.</small> | | |

| | | | |
|--|---------|-----------|-------|
| TOLERANCES UNLESS OTHERWISE SPECIFIED: | | | |
| DEC. | INCH | mm | ANGLE |
| .X | ±0.1 | [±2.5] | ±0.5° |
| .XX | ±0.03 | [±0.76] | |
| .XXX | ±0.005 | [±0.127] | |
| .XXXX | ±0.0005 | [±0.0127] | |
| REMOVE BURRS & BREAK SHARP EDGES: .003/.015 [0.076/.381] X 45° CORNER FILLETS: R.02 [51] | | | |
| MACHINED SURFACES: 125/3.2 | | | |
| mm SHOWN IN [BRACKETS] | | | |

| | |
|------------------------|--------------------|
| DRAWN BY AK | DATE 10-05-2009 |
| APPROVED BY SK | DATE 10-05-2009 |
| REFERENCE | |
| THIRD ANGLE PROJECTION | |

| | |
|----------------------------|--------------------------|
| Regal Beloit America, Inc. | |
| DESCRIPTION | OUTLINE 210 FR. TEFC |
| MATERIAL | PROCESS/FINISH |
| SIZE B | DRAWING NUMBER 037659 |
| | SHEET 1 OF 1 |



P.O. BOX 8003
WAUSAU, WI 54401-8003
PH. 715-675-3311

DATA VOLTS: 460

CERTIFICATION DATA SHEET

CUSTOMER P.O. #:
 ORDER #: EE7308 REFERENCE MODEL #: 213TTN16101
 CONN. DIAGRAM: 037659-912 CAT #: L411B
 OUTLINE: 215838 R5 6 CUSTOMER PART #:
 WINDING: MOUNTING: F1/F2 CAPABLE
 SPEED:
 TYPICAL MOTOR PERFORMANCE DATA

| HP | KW | SYNC RPM | FL RPM | FRAME | ENCLOSURE | TYPE | KVA CODE | DESIGN |
|----|-----|----------|--------|-------|-----------|------|----------|--------|
| 2 | 1.5 | 900 | 885 | 213T | TEFC | TEN | L | B |

| PH | HZ | VOLTS | AMPS | START TYPE | DUTY | INSL | S.F. | AMB | ELEV. |
|-------------|-----------------|-------------------------|---------------------------|-----------------|-------------|-----------|---------|-----------------|-------|
| 3 | 60/50 | 230/460#190/380 | 8/48.2/4.1 | ACROSS-THE LINE | CONT | F | 1.15 | 40 | 3300 |
| | F.L. EFF | 86.5 | 3/4 LD EFF | 86.0 | 1/2 LD EFF | 82.5 | GTD EFF | ELECT. TYPE | |
| | F.L. PF | 56.0 | 3/4 LD PF | 46.0 | 1/2 LD PF | 35.0 | 84.0 | SQ CAGE IND RUN | |
| F.L. TORQUE | LR AMPS @ 460 V | L.R. TORQUE | B.D. TORQUE | F.L. RISE (°C) | | | | | |
| 12.0 LB-FT | 24.0 | 27.5 LB-FT | 229% | 46.0 LB-FT | 383% | 25 | | | |
| @ 3 FT. | POWER | ROTOR WK ² | MAX. LOAD WK ² | SAFE STALL TIME | START/SHOUR | MOTOR WGT | | | |
| 52 DBA | 61 DBA | 0.95 LB-FT ² | 0 LB-FT ² | 20 SEC. | 4 | 215 LB. | | | |

*** SUPPLEMENTAL INFORMATION ***

| DE BRACKET TYPE | ODE BRACKET TYPE | MOUNT TYPE | MOTOR ORIENTATION | SEVERE DUTY | HAZARDOUS LOCATION | DRIP COVER | SCREENS | PAINT |
|------------------------|------------------|------------|-------------------|-------------|-------------------------|------------|----------------|---------------|
| STANDARD | STANDARD | RIGID | HORIZONTAL | NO | NONE | NO | NONE | BLUE (ENAMEL) |
| BEARINGS | GREASE | SHAFT TYPE | SPECIAL DE | SPECIAL ODE | SHAFT | MATERIAL | FRAME MATERIAL | |
| BALL BALL 6307 6208 | POLYREX EM | T | NONE | NONE | 1045 HOT ROLLED (C-204) | | CAST IRON | |

| THERMOSTATS | PROTECTORS | WDG RTD's | BRG RTD's | THERMISTORS | CONTROL | SPACE HEATERS |
|--------------|--------------|--------------|--------------|--------------|--------------------|---------------|
| NONE | NOT | NONE | NONE | NONE | FALSE | NA |
| R1 (ohms/ph) | R2 (ohms/ph) | X1 (ohms/ph) | X2 (ohms/ph) | Xm (ohms/ph) | VIBRATION (in/sec) | FLOAT |
| 1.931 | 1.86 | 9.017 | 10.622 | 81.366 | 0.150 | ODE |

| | | | |
|-----|--|---------------------------|--|
| * N | | INVERTER TORQUE: NONE | |
| O | | INV. HP SPEED RANGE: NONE | |
| T | | ENCODER: NONE | |
| E | | BRAKE: NONE | |
| S | | FT-LB: NONE | |
| | | VOLTAGE: NONE | |
| | | HZ: NONE | |

PREPARED BY: FAREEDA DUDEKULA
 DATE: 9/11/2018
 FORM: 3531 REV 4 2/27/06
 UL: V:INS, CONST UL REC

Data Sheet

213TFFN16101



Submital
Data @ 460 V

Date: 9/11/2018
 Customer: _____
 Attention: _____
 Submitted by: FAREEDA DUDEKULA

| Load | Motor Load Data | | | | | | | | | |
|----------------|-----------------|------|------|------|------|------|------|------|--|--|
| | 0% | 25% | 50% | 75% | 100% | 115% | 125% | LR | | |
| Current (Amps) | 2.70 | 3.1 | 3.3 | 3.6 | 4.0 | 4.2 | 4.5 | 24.0 | | |
| Torque (ft-lb) | 0.00 | 3.0 | 6.0 | 9.0 | 12.0 | 13.8 | 15.0 | 27.5 | | |
| RPM | 900 | 895 | 891 | 888 | 885 | 880 | 878 | 0 | | |
| Efficiency (%) | | 72.0 | 82.5 | 86.0 | 86.5 | 86.5 | 87.0 | | | |
| P.F. (%) | 7.0 | 21.0 | 35.0 | 46.0 | 56.0 | 60.0 | 62.0 | 40.0 | | |

| Motor Speed Data | | | | | |
|------------------|------|---------|------|-------|------|
| | LR | Pull-Up | BD | Rated | Idle |
| Speed (RPM) | 0 | 450 | 770 | 885 | 900 |
| Current (Amps) | 24.0 | 21.5 | 16.0 | 4.0 | 2.70 |
| Torque (ft-lb) | 27.5 | 24.5 | 46.0 | 12.0 | 0.00 |

| Information Block | | | | |
|-----------------------------|-------------------------|--------|---------|---------|
| HP | 2.0 | | | |
| Sync. RPM | 900 | | | |
| Frame | 2151B2TFC080 | | | |
| Enclosure | TEFC | | | |
| Construction | TFN | | | |
| Voltage | 230/460#190/380 V | | | |
| Frequency | 60 Hz | | | |
| Design | B | | | |
| LR Code letter | L | | | |
| Service Factor | 1.15 | | | |
| Temp Rise @ FL | 25 °C | | | |
| Duty | CONT | | | |
| Ambient | 40 °C | | | |
| Elevation | 1,000 feet | | | |
| Rotor/Shaft wk ² | 0.95 Lb-Ft ² | | | |
| Ret Wdg | 215838 F5 | | | |
| Sound Pressure @ 1M | 52 DBA | | | |
| VFD Rating | NONE | | | |
| Outline Dwg | 037659-912 | | | |
| Conn. Diag | EE7308 | | | |
| Additional Specifications: | | | | |
| EQUIV CKT (OHMS / PHASE) | | | | |
| R1 | R2 | X1 | X2 | Xm |
| 1.9310 | 1.8800 | 9.0170 | 10.6220 | 81.3660 |

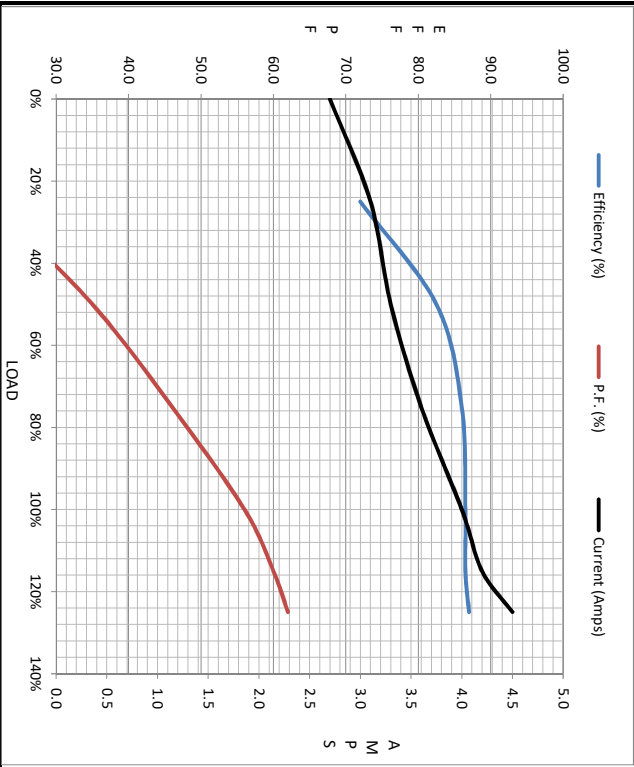

| Information Block | | | | |
|-----------------------------|-------------------------|--------|---------|---------|
| HP | 2.0 | | | |
| Sync. RPM | 900 | | | |
| Frame | 2151B2TFC080 | | | |
| Enclosure | TEFC | | | |
| Construction | TFN | | | |
| Voltage | 230/460#190/380 V | | | |
| Frequency | 60 Hz | | | |
| Design | B | | | |
| LR Code letter | L | | | |
| Service Factor | 1.15 | | | |
| Temp Rise @ FL | 25 °C | | | |
| Duty | CONT | | | |
| Ambient | 40 °C | | | |
| Elevation | 1,000 feet | | | |
| Rotor/Shaft wk ² | 0.95 Lb-Ft ² | | | |
| Ret Wdg | 215838 F5 | | | |
| Sound Pressure @ 1M | 52 DBA | | | |
| VFD Rating | NONE | | | |
| Outline Dwg | 037659-912 | | | |
| Conn. Diag | EE7308 | | | |
| Additional Specifications: | | | | |
| EQUIV CKT (OHMS / PHASE) | | | | |
| R1 | R2 | X1 | X2 | Xm |
| 1.9310 | 1.8800 | 9.0170 | 10.6220 | 81.3660 |

